

HDS-42 42' Hammer Discus Stopper System Specification

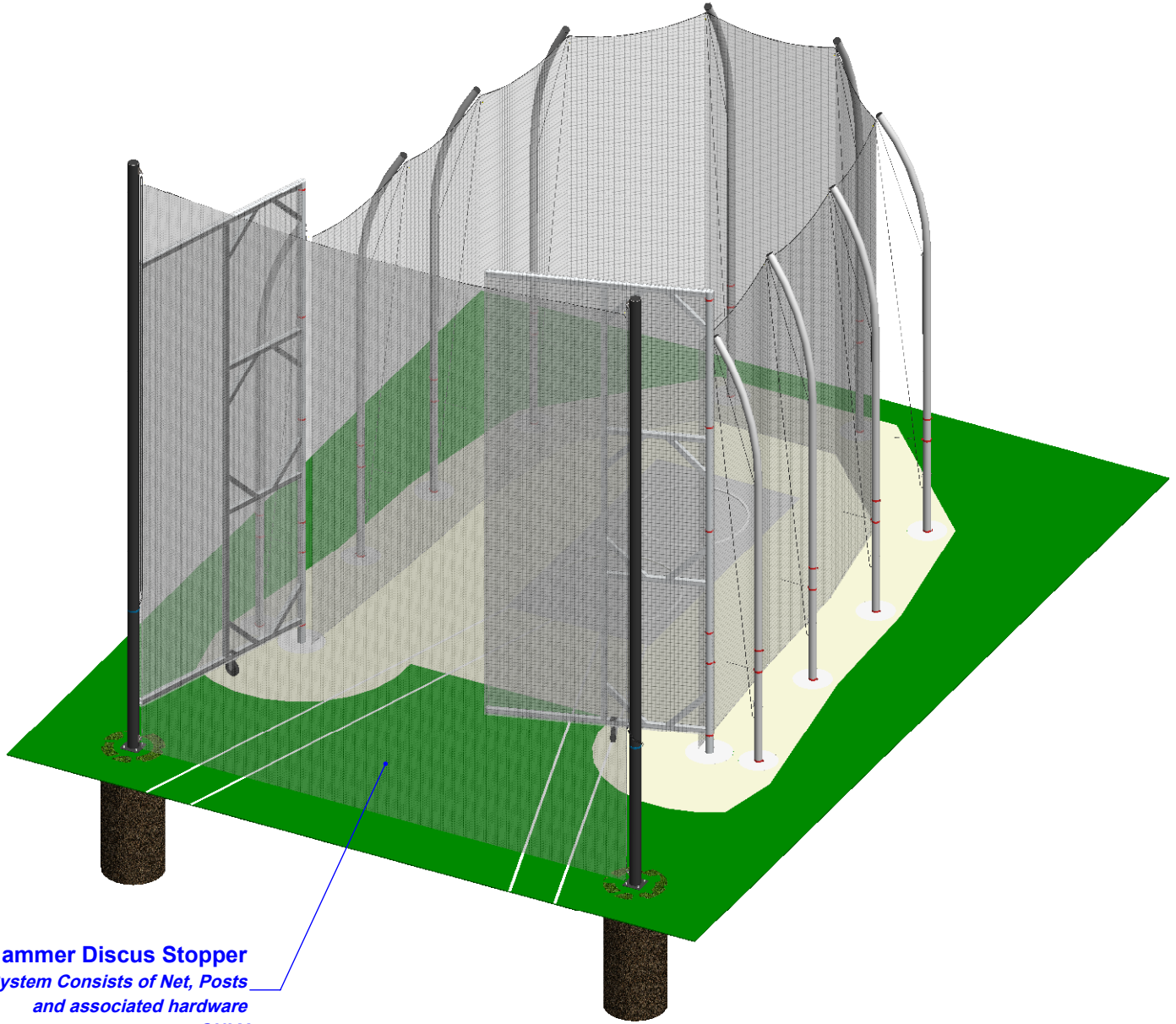

Hammer Discus Stopper
System Consists of Net, Posts
and associated hardware
ONLY

HDS-42 Layout Specifications

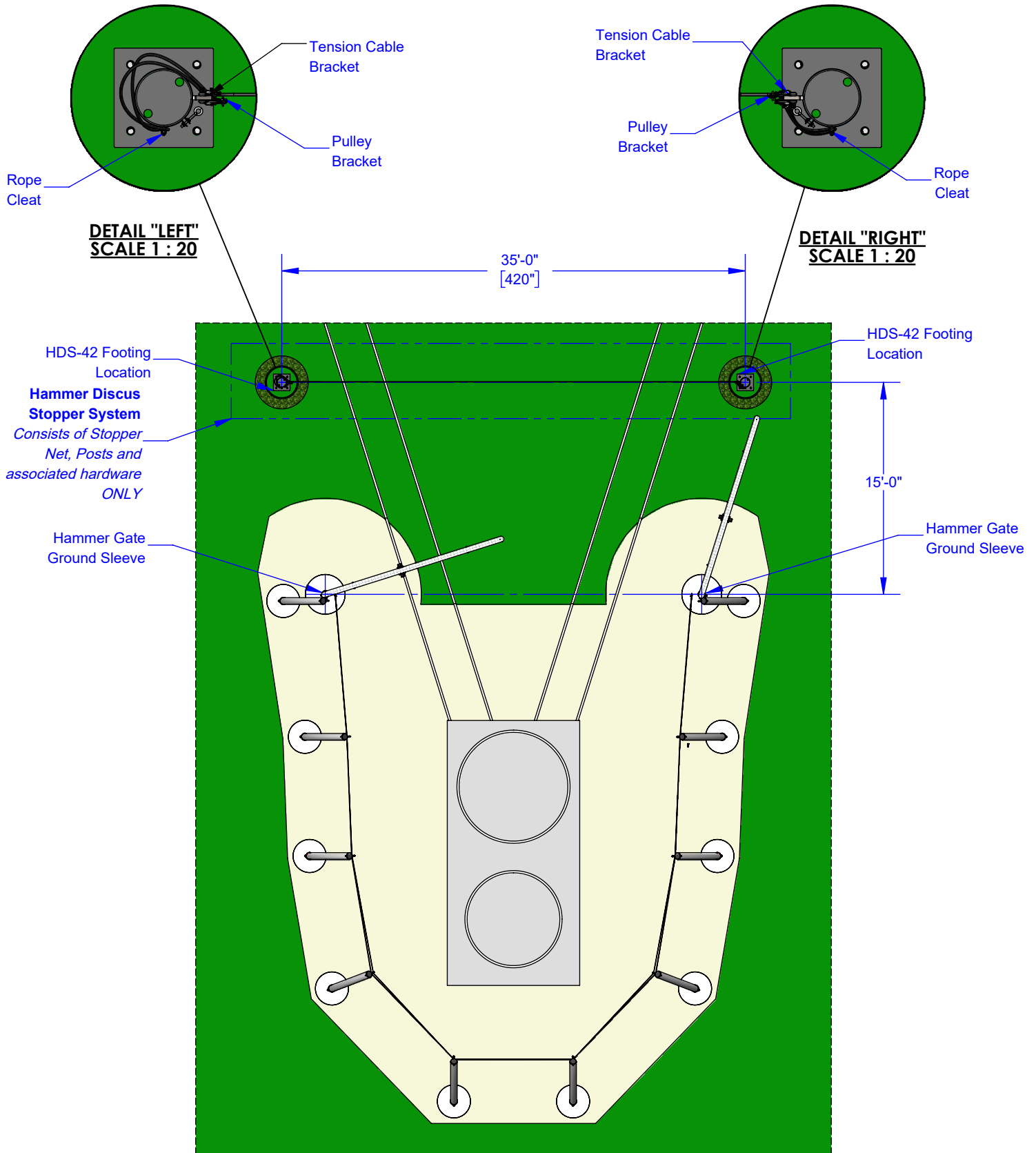

HDS-42 Concrete Footing Specifications

Natural Grass Field Footing Specification

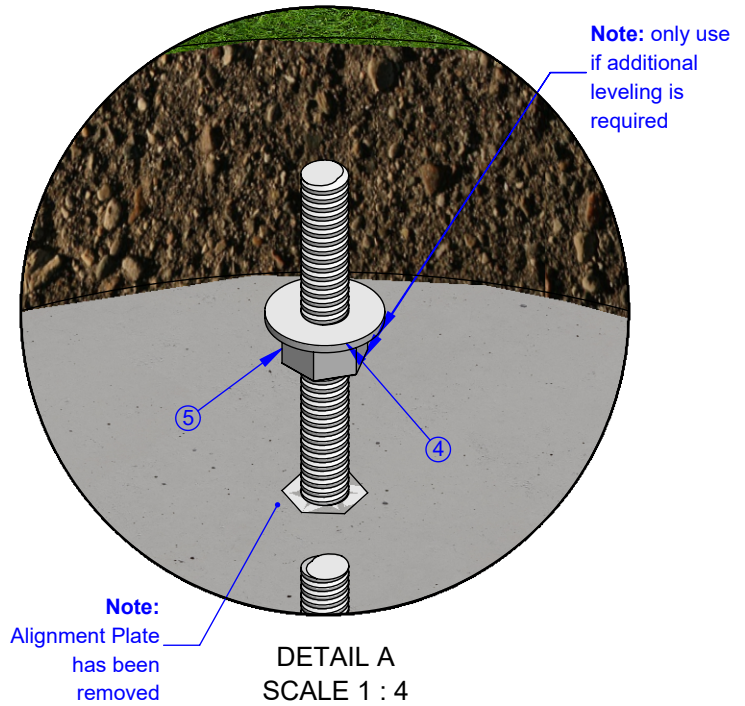
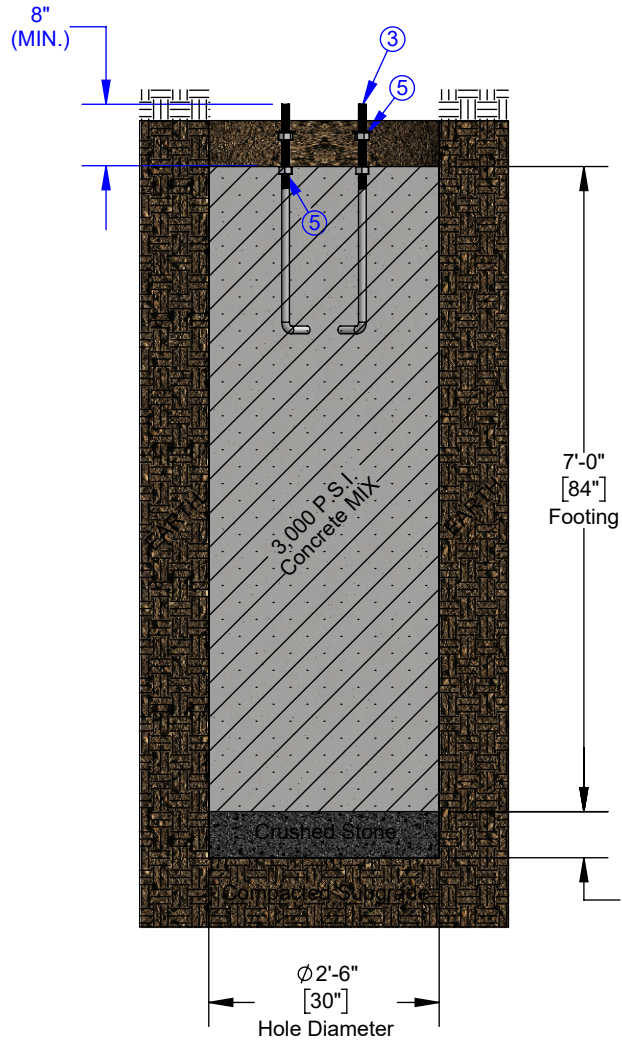

Note: After concrete has set, alignment plate and the (4) hex nuts used to hold it in place are to be removed.
DO NOT DISCARD HEX NUTS, as they may be used if additional leveling is required.



Aluminum Athletic Equipment
1000 Enterprise Drive, Royersford, PA 19468
Toll Free: (800) 523-5471 Fax: (610) 825-2378
www.AAEsports.com

DESCRIPTION			
Concrete Footing Specification			
NOTE: Grass & Turf Footing Specification			
MODEL:	HDS-42	CATEGORY:	CUSTOMER
DATE:	11/22/2021		
DRAWN BY:	CAD FILE:	DWG. NO.	
N.R.	HDS-42 Specifications Plate Mount	HDS-42-C-003	

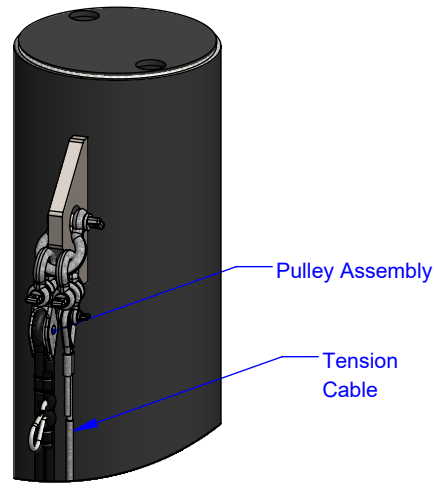

Upper Brackets

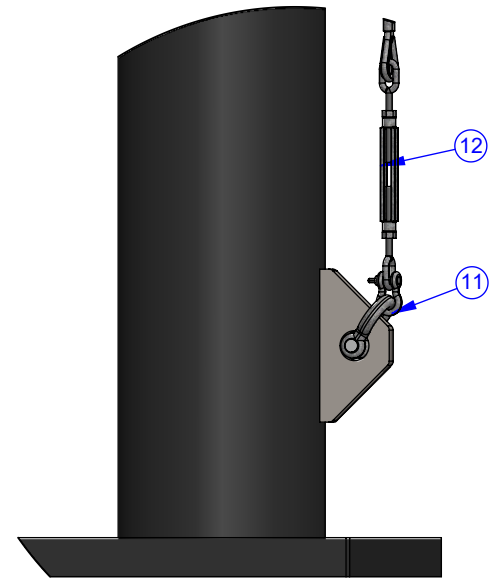

Bottom Bracket

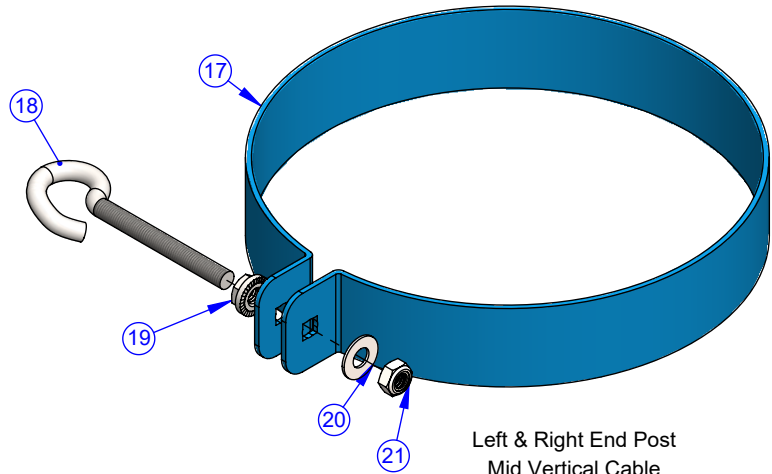

Left & Right End Post
Mid Vertical Cable
"Open Eyebolt"
Collar Assembly

**HDS-42
Cable Collar/Hardware
Assembly Diagrams**

 Aluminum Athletic Equipment 1000 Enterprise Drive, Royersford, PA 19468 Toll Free: (800) 523-5471 Fax: (610) 825-2378 www.AAEsports.com			
DESCRIPTION			
HDS-42 Assembly Instructions			
NOTE: Various Collar/Hardware Assemblies			
MODEL:	HDS-42	CATEGORY:	CUSTOMER
		DATE:	11/22/2021
DRAWN BY:	NR	CAD FILE:	HDS-42 Specifications Plate Mount
		DWG. NO.	HDS-42-C-004

HDS-42

Assembly Instruction

Left End Post

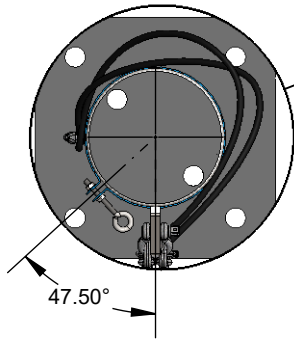

Welded Bracket Orientation

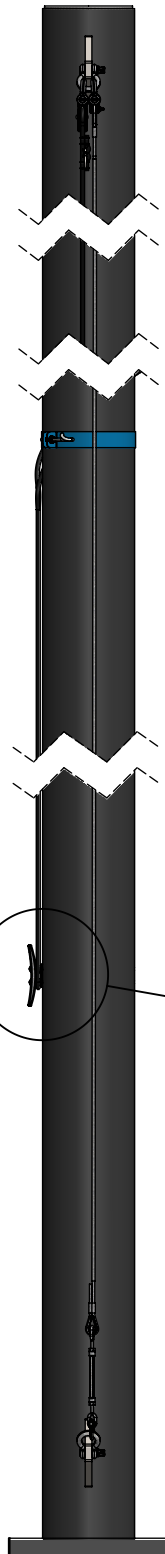
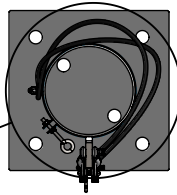

Front View

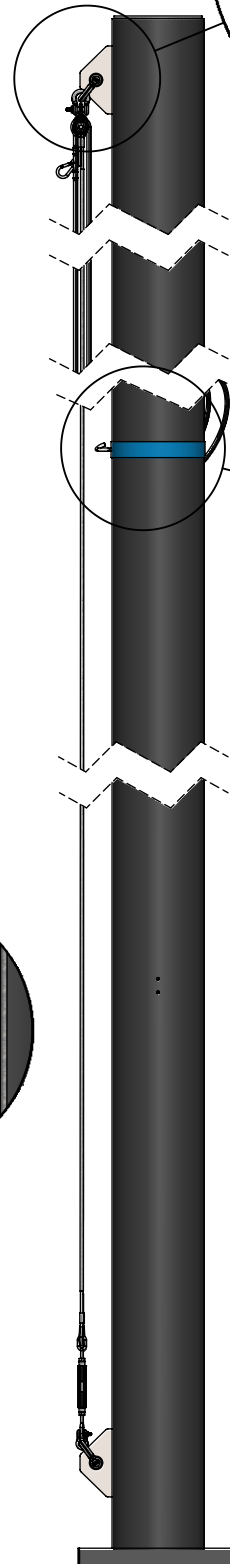

Right View

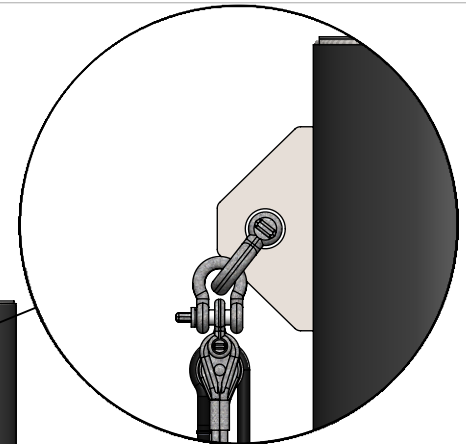

Tension Cable Bracket

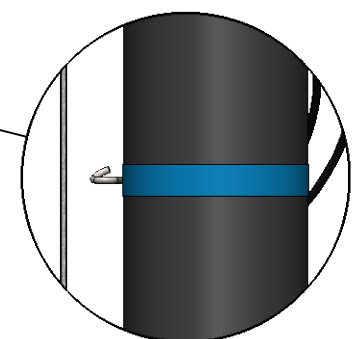

Open Eyebolt Collar Detail

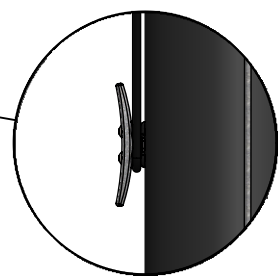

Cleat Detail

Installation Notes:

1. **Lower Bracket:** Install anchor shackles and tensioner cable prior to anchoring uprights.
2. **Cleat:** Is drilled and tapped into a fixed position (*refer to diagram*)
3. **Mid Collar:** Note orientation of collar on post. From top of pole slide the open eyebolt collar into position (*refer to diagram*) and secure into place.
4. **Pulley:** Pulley system comes preassembled to anchor shackles. Install anchor shackle to the bracket at top of post. (*refer to diagram*)
5. **Upper Bracket:** Large anchor shackle gets attached to top bracket and two medium shackles attach to the large for the hanging pulley and vertical tension cable, be sure to orient vertical tension cable on the side of the bracket that will be facing the field of play. (*refer to diagram*)
6. Make sure warning labels are present on goal posts.

Note:
Post assembly should be done with post laying down on flat level surface.



Aluminum Athletic Equipment
1000 Enterprise Drive, Royersford, PA 19468
Toll Free: (800) 523-5471 Fax: (610) 825-2378
www.AAEsports.com

HDS-42

Assembly Instruction

Right End Post

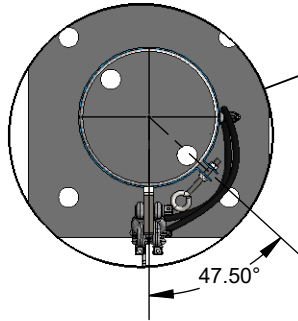

Welded Bracket Orientation

Installation Notes:

1. **Lower Bracket:** Install anchor shackles and tensioner cable prior to anchoring uprights.
2. **Cleat:** Is drilled and tapped into a fixed position (*refer to diagram*)
3. **Mid Collar:** Note orientation of collar on post. From top of pole slide the open eyebolt collar into position (*refer to diagram*) and secure into place.
4. **Pulley:** Pulley system comes preassembled to anchor shackles. Install anchor shackle to the bracket at top of post. (*refer to diagram*)
5. **Upper Bracket:** Large anchor shackle gets attached to top bracket and two medium shackles attach to the large for the hanging pulley and vertical tension cable, be sure to orient vertical tension cable on the side of the bracket that will be facing the field of play. (*refer to diagram*)
6. Make sure warning labels are present on goal posts.

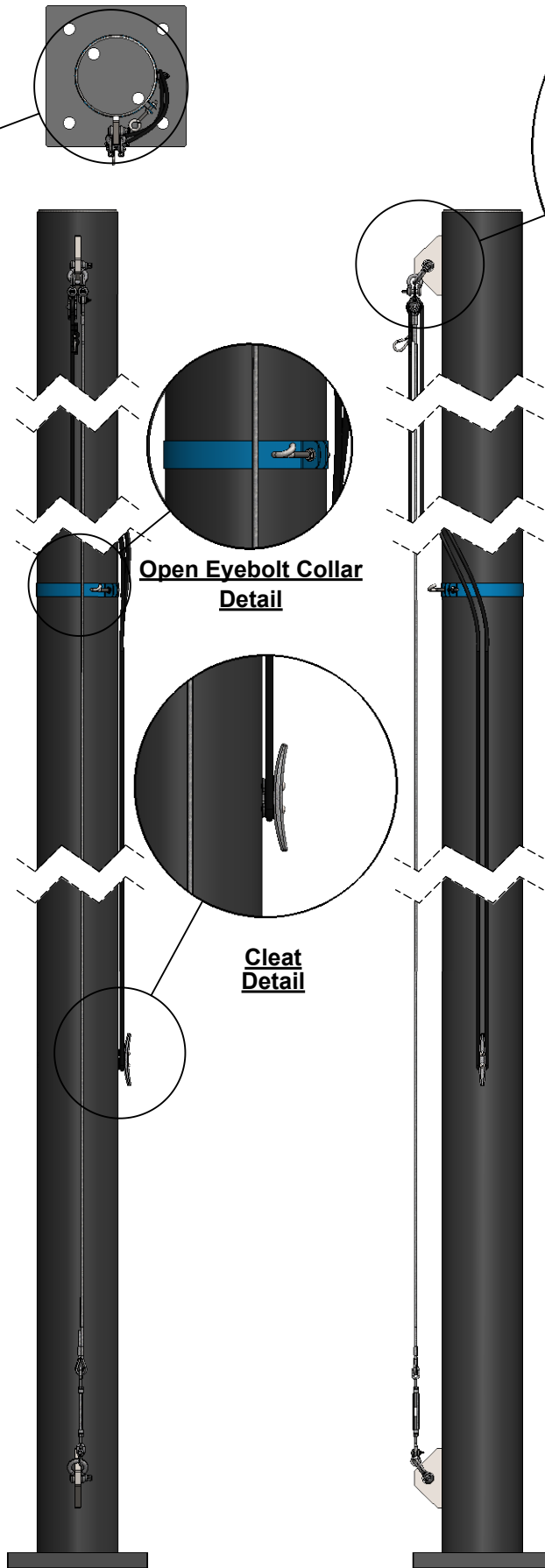

Front View

Right View

Note:
Post assembly should be done with post laying down on flat level surface.



Aluminum Athletic Equipment
1000 Enterprise Drive, Royersford, PA 19468
Toll Free: (800) 523-5471 Fax: (610) 825-2378
www.AAEsports.com

HDS-42

Assembly Instruction

Net Attachment

Note: When raising net, it must be done in increments across the entire span

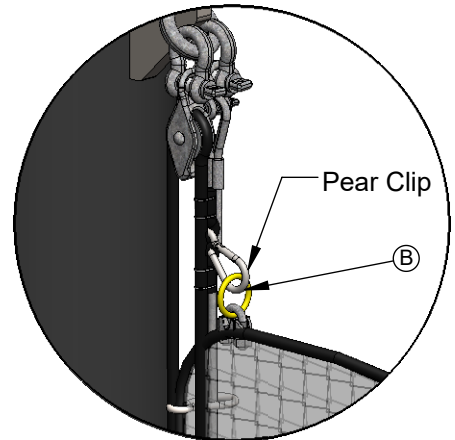
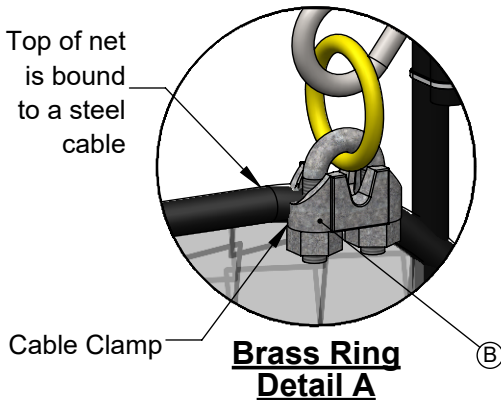
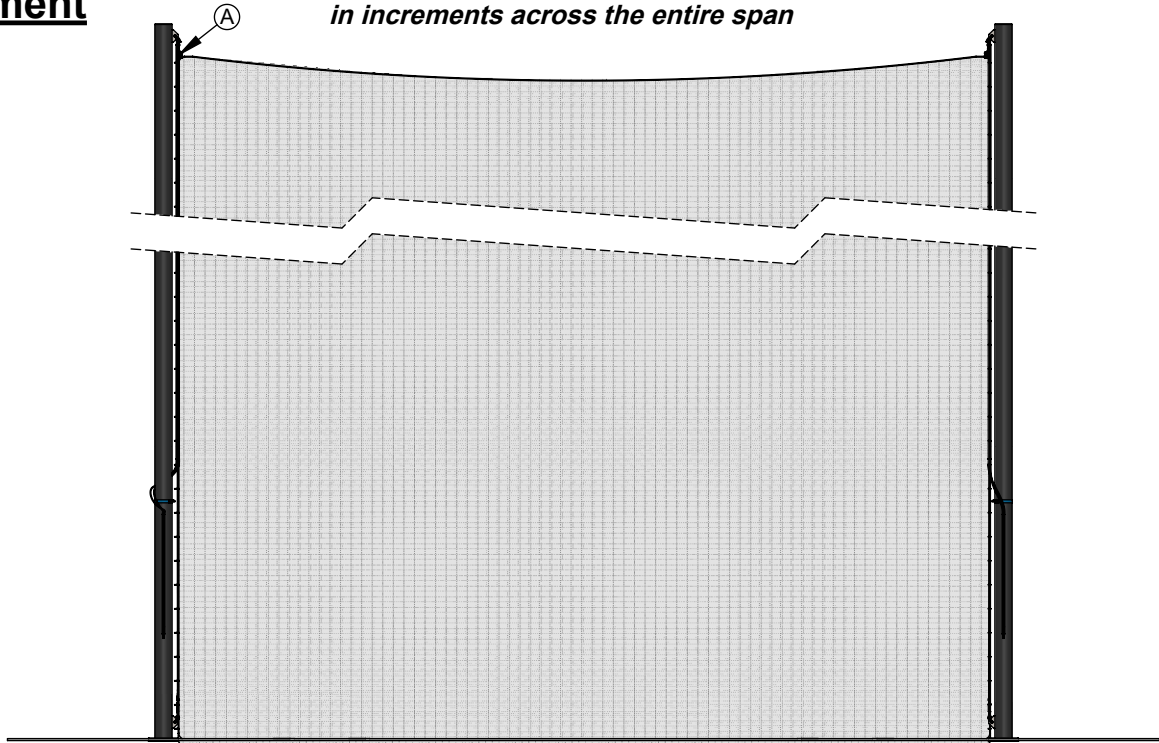

Installation Notes:

1. Lay net on ground across span of posts. *Make sure net is centered across span of posts.*
2. Using a Pear Clip Secure upper net corners to End Post Vertical Support Cables *(as shown in Detail C)*
3. Secure Brass Rings to top of net using Cable Clamp *(as shown in Detail A)*. One ring and clamp per post and they should be centered as close as possible to its coinciding post.
4. After Brass Rings have been secured to net, clip ring into it's posts hoist system Pear Clip *(as shown in Detail B)*.
5. As net is being raised make sure to secure net sides to the vertical support cables using provided **Pear Clips** *(refer to Detail C)*. Pear Clips should be spaced approx. 12" or 9 net squares.
6. Once net has been completed raised tie hoist ropes onto cleat.

Note: Hardware denoted with "B" is included in item #3 "Hoist Rope"

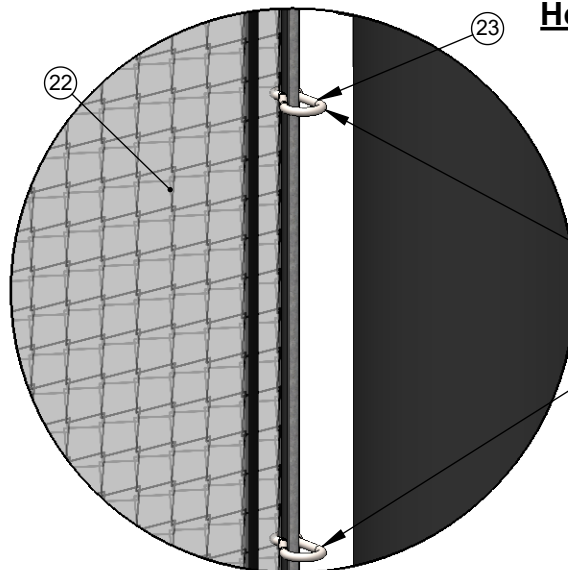

Net to End Post Vertical Support Cable Detail C

Pear Clips Spaced approx. every 12", entire length of vertical cable *(Left and Right End Posts Only)*



Aluminum Athletic Equipment
 1000 Enterprise Drive, Royersford, PA 19468
 Toll Free: (800) 523-5471 Fax: (610) 825-2378
www.AAEsports.com