

Model No.: HSAH-III

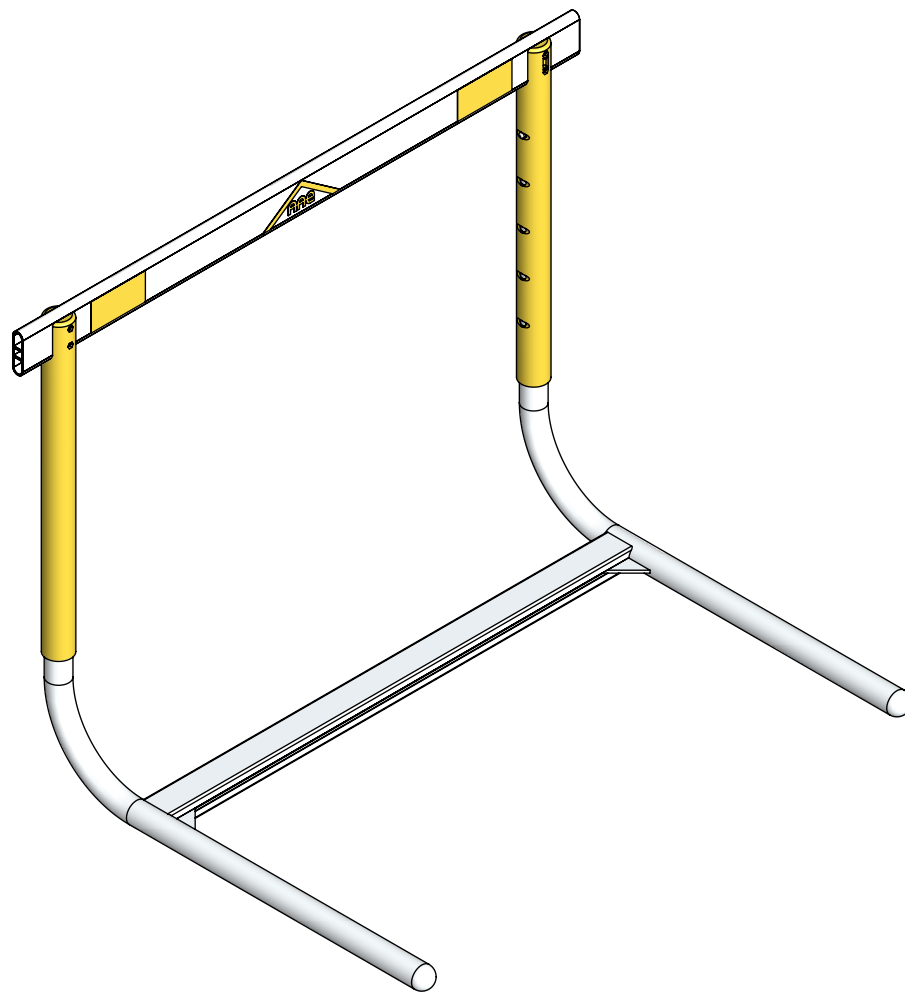

Aluminum Athletic Equipment
1000 Enterprise Drive, Royersford, PA 19468
Toll Free: (800) 523-5471 Fax: (610) 825-2378
www.AAEsports.com

HSAH III - Specifications

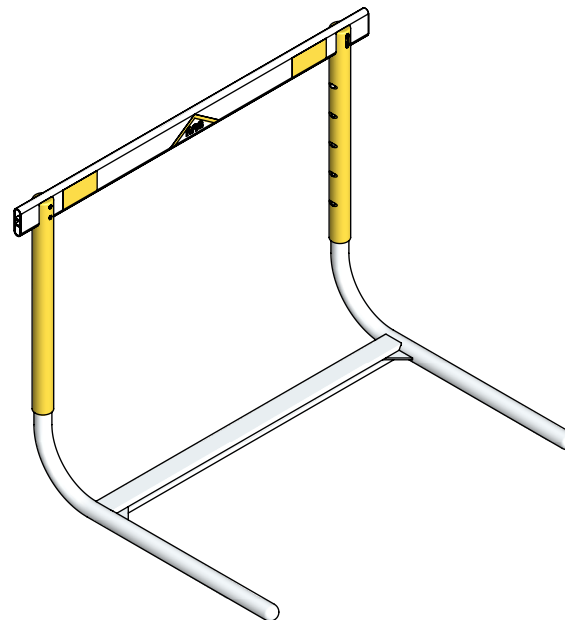
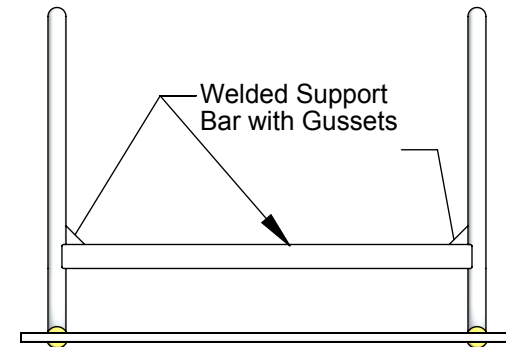
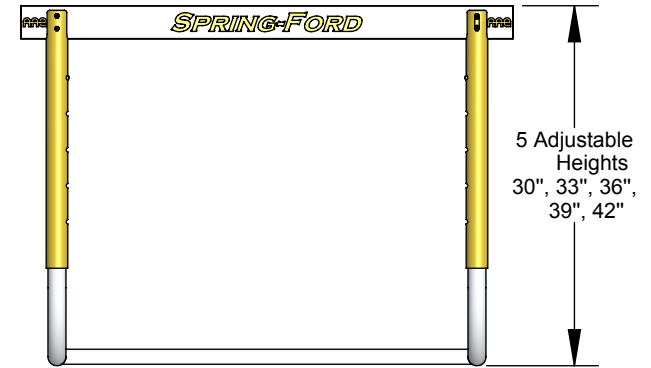
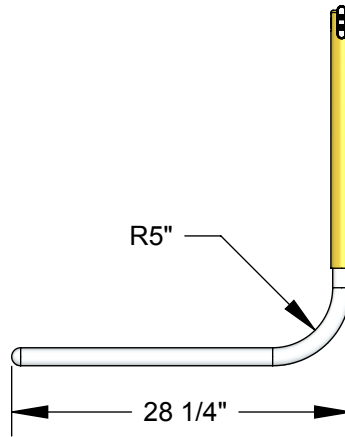
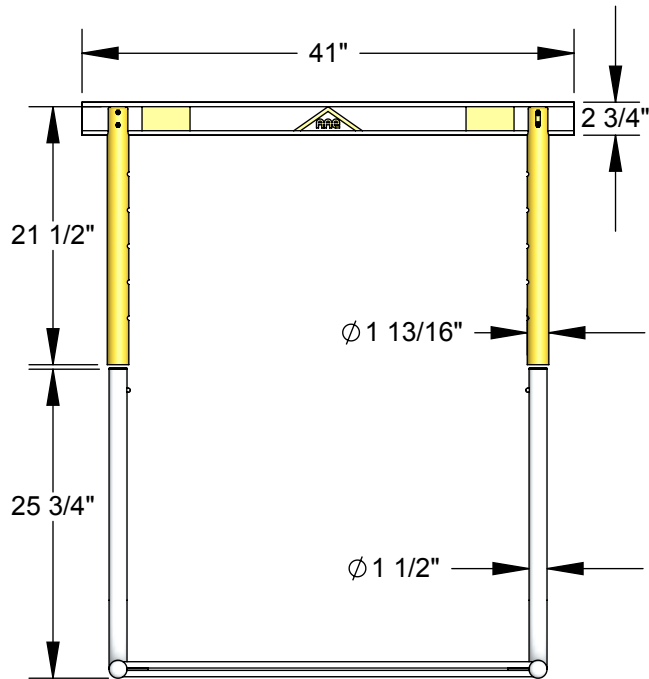

FEATURES:

- * AAE Standard Lifetime Guarantee
- * Completely welded aluminum hurdle with gussets welded internally to Aero-space designed u-slotted extrusion for maximum strength
- * Back crosstube moved from 24" to 8" off front
- * Stainless Steel, low profile, hurdle board hardware
- * 6063T832 tempered aluminum base tubes
- * G. E. Lexan board with school name or logo
- * Exclusive "L" shaped base controls rocker action
- * Center mounted, "vise gripped" hurdle board
- * UV-stabilized polycarbonate telescoping tubes in color of choice
- * Completely sealed weights - meets pullover requirement at all heights
- * Hurdle board is guaranteed for 2 years



Aluminum Athletic Equipment
1000 Enterprise Drive, Royersford, PA 19468
Toll Free: (800) 523-5471 Fax: (610) 825-2378
www.AAEsports.com

DESCRIPTION			
HSAH III - Specifications			
NOTE: Welded Single Bar High School Rocker Hurdle			
MODEL:	HSAH III	CATEGORY:	CUSTOMER
		DATE:	10/11/11
DRAWN BY:	ARP	CAD FILE:	HSAH-III Packet
		DWG. NO.:	HSAH-III-C-001

STEP NO. 1

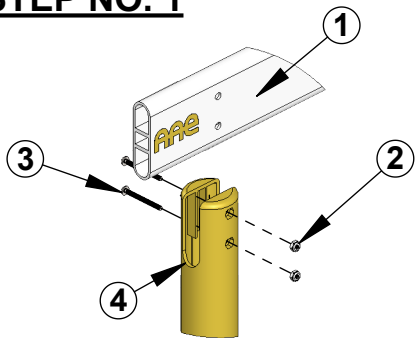

DETAIL A
SCALE 1 : 6

STEP NO. 2

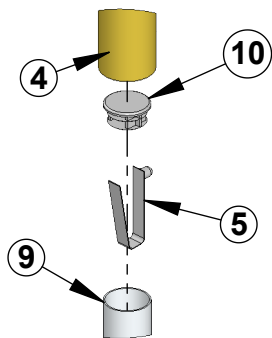

DETAIL B
SCALE 1 : 6

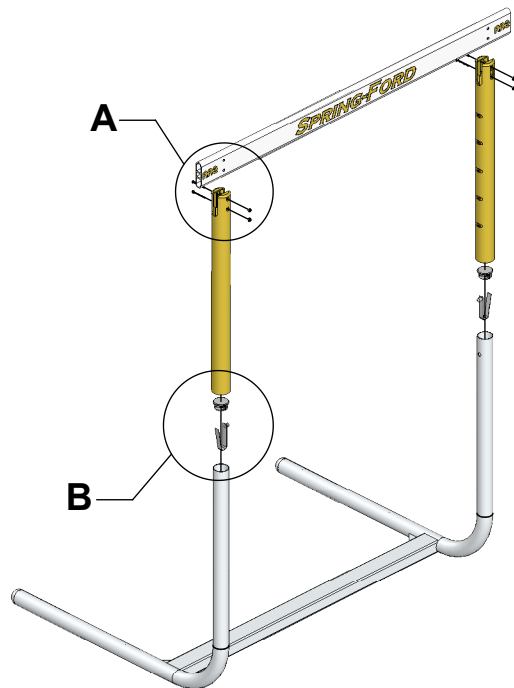

OPERATION

HSAH III - Assembly

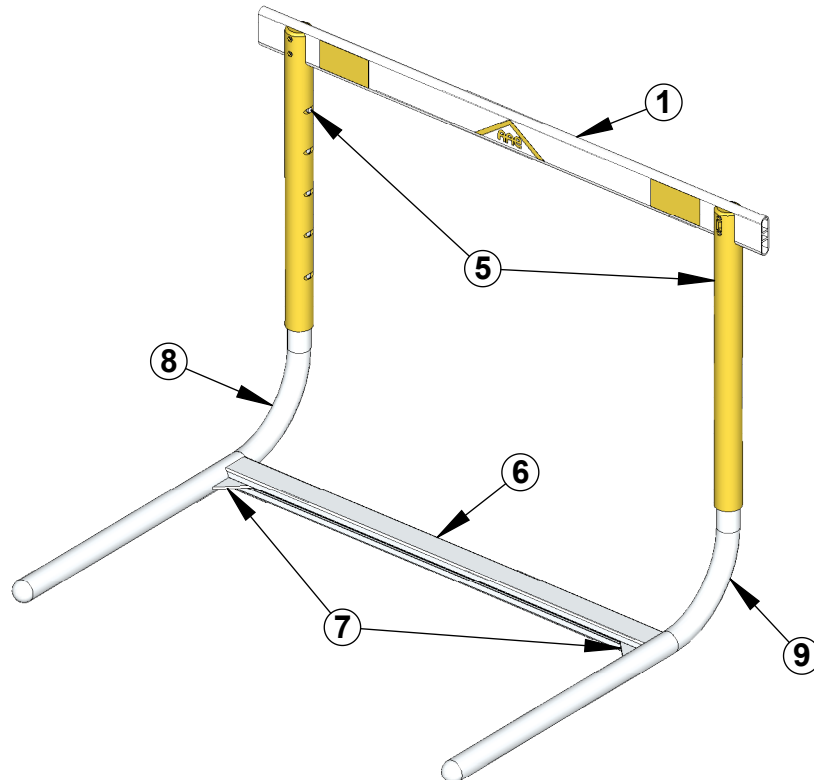

Tools Required: Hammer, Screwdriver (flat & phillips)

NOTE : Unibody Aluminum Frame is completely welded. (No Assembly Required)

STEP NO. 1 - Assembling Hurdle Board

- A. Center the holes in the hurdle board, #1, over telescope tubes, #4, and tap into slot.
- B. Align holes and insert aluminum post, #2, and fasten tight with binding screw, #3.

STEP NO. 2 - Insert Push Button Locking Device & Plug

- A. If not already installed, squeeze locking device, #5 and align button with hole on leg, push down using a flathead screwdriver.
- B. If not already installed, using a hammer tap in plastic plug, #10

OPERATION - Adjusting Hurdling Heights

- A. Face front side of hurdle and position your left and right foot on base tubes, #8 & #9, respectively.
- B. Depress locking devices, #5, with first joint of thumb (NOT finger tips) and raise or lower hurdle tubes and board.

Maintenance

- A. Store inside during off-season.
- B. Before storing, turn hurdle upside down to allow any water out. Should be minimal due to plug.
- C. Remove hurdle top, clean and lubricate base tube (yearly).
- D. Tighten all hardware regularly.
- E. Replace any broken parts immediately.

Important Note:

The sealed weights in the base tubes should stay to the rear of the base tubes at all times!



Aluminum Athletic Equipment
1000 Enterprise Drive, Royersford, PA 19468
Toll Free: (800) 523-5471 Fax: (610) 825-2378
www.AAEsports.com

DESCRIPTION

HSAH III- ASSEMBLY

NOTE:

**** Read all Important Notes & Cautions before operating hurdle.**

MODEL:

HSAH III

CATEGORY:

CUSTOMER

DATE: 11/15/01

DRAWN BY:

TAD

CAD FILE:

HSAH III Assembly

DWG. NO.

HSAH III-C-002