

NSC - Net Storage Cart

Specifications

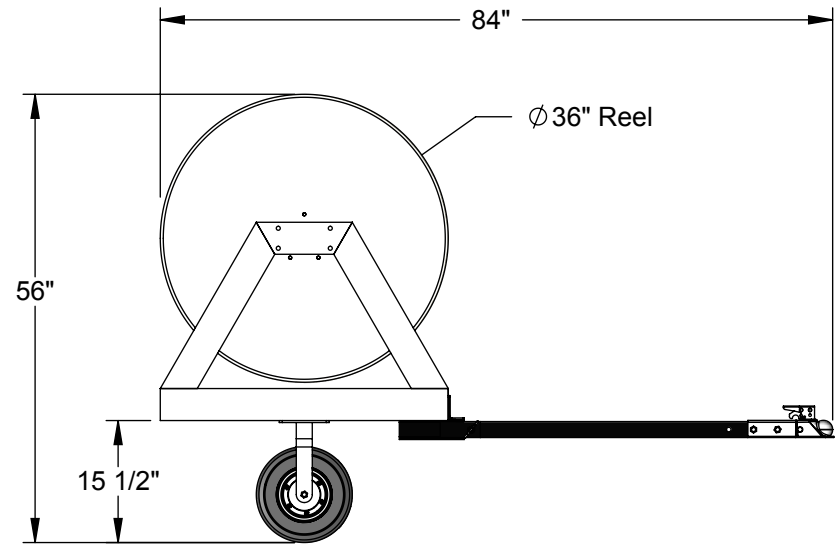

Hitch Attachment - Tow Position

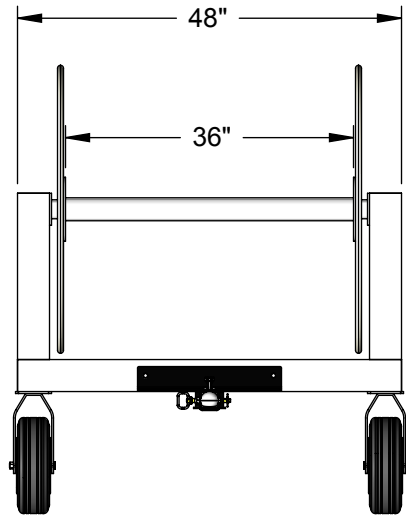
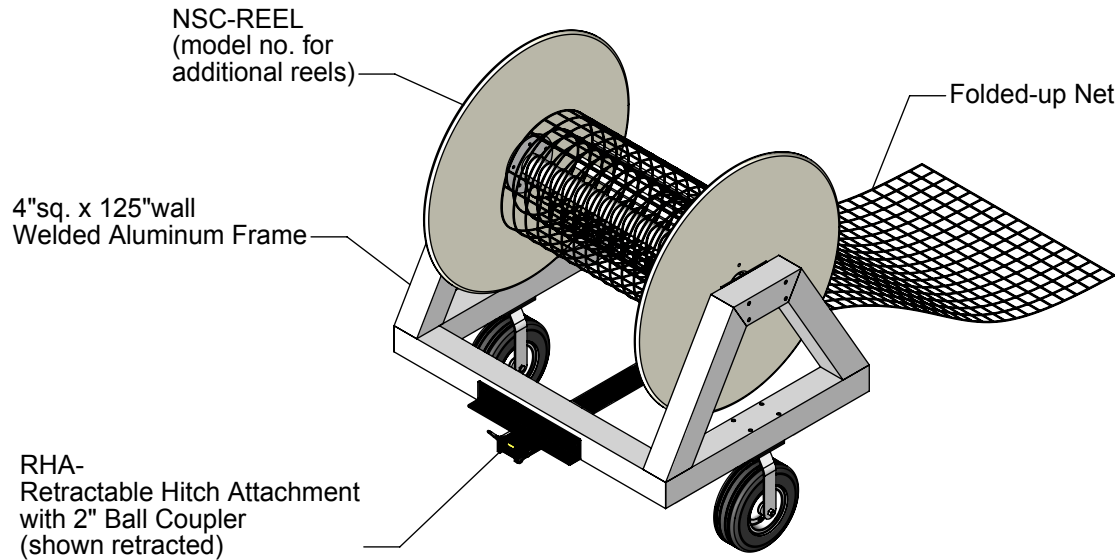

Notes/Features:

- Approx. Weight = 150lbs.
- Welded All-Aluminum Components
- Retractable Galvanized Steel Hitch
- 12" Semi-Pneumatic Fixed Wheel Casters
- Maximum Net Capacity = 5000 sqft
- NSC-REEL - additional reels available for use with the NSC to store other nets.



Aluminum Athletic Equipment
 1000 Enterprise Drive, Royersford, PA 19468
 Toll Free: (800) 523-5471 Fax: (610) 825-2378
www.AAEsports.com

DESCRIPTION:			
NSC - Net Storage Cart - Specifications			
NOTE: Welded Aluminum Components			
MODEL:	NSC	CATEGORY:	CUSTOMER
		DATE:	8/16/07
DWN. BY:	TAD	CAD FILE:	NSC - Specs
		DWG. NO.	NSC-C-001