

PRS-CART Specifications

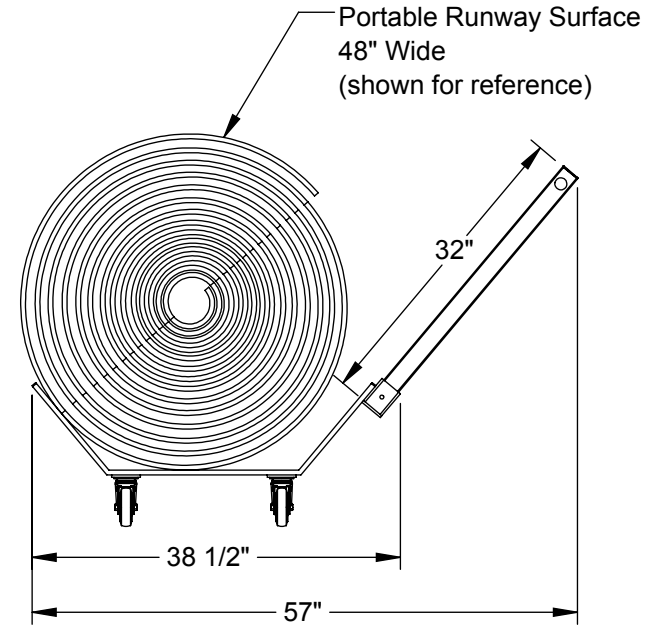
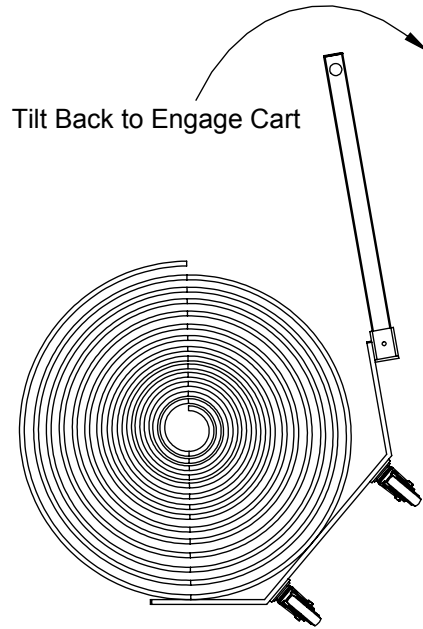
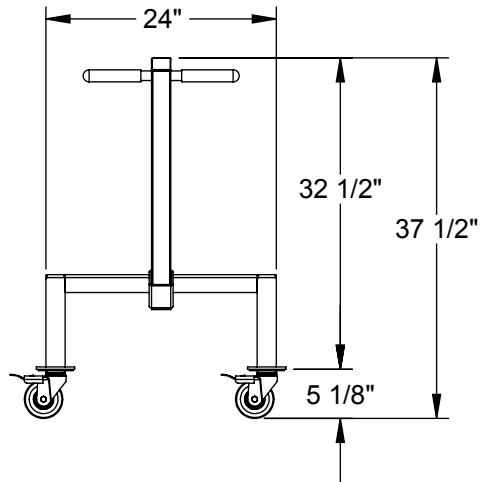

Total Weight = 60 lbs.

Max Capacity = 1,000 lbs.

Welded Cradle
Frame Assembly
Steel Flat Bar
(42 lbs.)

Arm Assembly
Square Steel Tube
Vinyl-coated black
(10 lbs.)

4" dia. Swivel Caster
Wheels, Lockable
(2 lbs. each)

Cushioned Rubber Grips



Aluminum Athletic Equipment
1000 Enterprise Drive, Royersford, PA 19468
Toll Free: (800) 523-5471 Fax: (610) 825-2378
www.AAEsports.com

DESCRIPTION:		
PRS-CART - Specifications		
NOTE: Maximum Weight Capacity 1,000 lbs.		
MODEL: PRS-CART	CATEGORY: CUSTOMER	DATE: 10/23/2017
DWN. BY: CED	CAD FILE: PRS-CART - Specifications	DWG. NO. PRS-CART-C-001